

Please read the attached notes before attempting to complete the form.  
Full replies to all the questions will help in dealing with the application  
expeditiously.

County District Ref. No.

RD 3 192 W

For use by the County Council

Number TCP/ 5267C/20

Date received 24 FEB 1961

## ISLE OF WIGHT COUNTY COUNCIL.

TOWN AND COUNTRY PLANNING ACTS, 1947-1959.

APPLICATION FOR PERMISSION TO DEVELOP LAND

(to be completed in triplicate)

\*To the I.W.R.D.C.

I/We hereby apply for permission to carry out the development described in this application and  
on the attached plans and drawings.

(Signed)

Date February 22nd. 1961.

Telephone No. of person signing application Newport 2663.

### PART I—GENERAL.

(in this part the word "land" includes any buildings thereon.)

(1) Name and address of applicant (IN BLOCK LETTERS)

Surname ROYAL SOLENT YACHT CLUB Other names

Postal Address YARMOUTH I.W.

(2) If the application has been signed by an Agent, please state

Name of Agent E.L. Smith & Son Profession Chartered Architects

Postal Address 21 Quay St., Newport. I.W.

(3) (i) Particulars of the applicant's interest  
in the land (e.g., owner, lessee,  
prospective purchaser, etc.).

(ii) If the applicant is a prospective  
purchaser or lessee of the land, state  
whether the vendor or the lessor has  
consented to the proposed develop-  
ment.

(3) (i)  
Owners.

(ii)

(4) Address or location of the land to be  
developed, in sufficient detail to enable  
it to be readily identified.

(4)  
Yarmouth I.W.  
Please see plan.

\* This application should be addressed to the offices of the Borough or District Council in whose  
area the land is situated. These addresses are given on the attached sheet of notes.



PART I—GENERAL (cont.)

(5) Describe briefly the proposed development including the purpose for which the land and/or buildings are to be used. If they are to be used for more than one purpose, give details. See note (a) attached.	(5)  <b>Building of a boat shed.</b>
(6) State the purpose for which the land and/or buildings are <i>now</i> used, and if used for more than one purpose, give details.	(6)  <b>Open space within the Yacht Club premises.</b>
(7) State whether the proposed development involves the construction of a new, or the alteration of an existing, access to or from a highway. If so, state whether the new or altered access is required for vehicular traffic.	(7)  <b>No</b>

PART II—ADDITIONAL INFORMATION REQUIRED ONLY IF THE APPLICATION  
IS FOR THE CONSTRUCTION OF A BUILDING.

(If there is more than one building, give separate particulars for each.)

(8) Is the site within a layout plan for which permission has been granted by the County Council? If so, state the code number and date of permission.	(8)  <b>Not known.</b>
(9) If the building is to be used wholly or partly for residential purposes state:  (i) the number of habitable rooms. See note (b) attached;  (ii) the total floor area of the non-residential part, if any. See note (c) attached.	(9) (i)    (ii)
(10) If the building is to be used wholly or partly for industrial or commercial use, state:  (i) the nature of the proposed industry or business, including, if for industrial use, a brief description of the type of processes to be carried on;  (ii) the total floor area. See note (c) attached;  (iii) the intending provisions for the loading and unloading of vehicles;  (iv) if for industrial use, the means of disposal of any trade refuse or trade effluents.	(10)  (i)  (ii)  (iii)  (iv)

The applicant may use this space (together with attached sheets if necessary) to supply additional information:—

FORM 2.  
Uncon.

Application No. TCP/5267C RD / 3192W

**FORM OF PERMISSION FOR DEVELOPMENT.**

**THE TOWN AND COUNTRY PLANNING ACTS, 1947-1959.**

**THE TOWN AND COUNTRY PLANNING (GENERAL DEVELOPMENT)  
ORDER, 1950.**

**ISLE OF WIGHT COUNTY COUNCIL.**

To: Royal Solent Yacht Club

of: c/o Messrs. E.L. Smith & Son, 21, Quay Street, Newport, I.W.

In pursuance of their powers under the above-mentioned Act and Order the Council hereby permit the erection of a boat shed, Royal Solent Yacht Club, Yarmouth, I.W.

in accordance with the submitted plans.

The permission is granted subject to compliance with any byelaws, local acts, orders and regulations, and general statutory provisions in force.

Dated 23rd March, 1961.

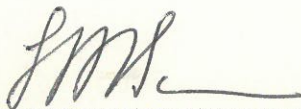

.....  
*Clerk of the County Council.*

PLEASE NOTE this planning approval does not authorise any work to be carried out until you have obtained approval under building bye-laws or under any other act, order or regulation, and, if necessary, obtained a building licence.



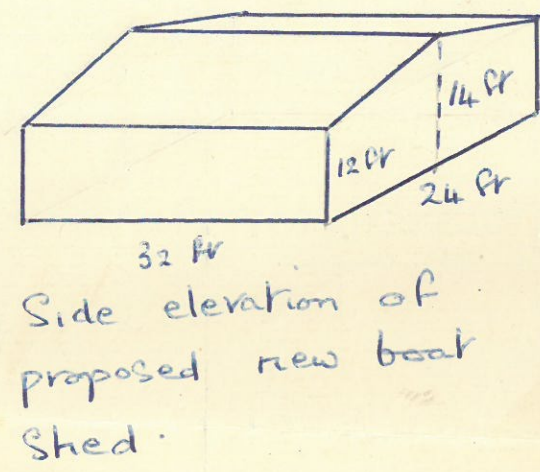
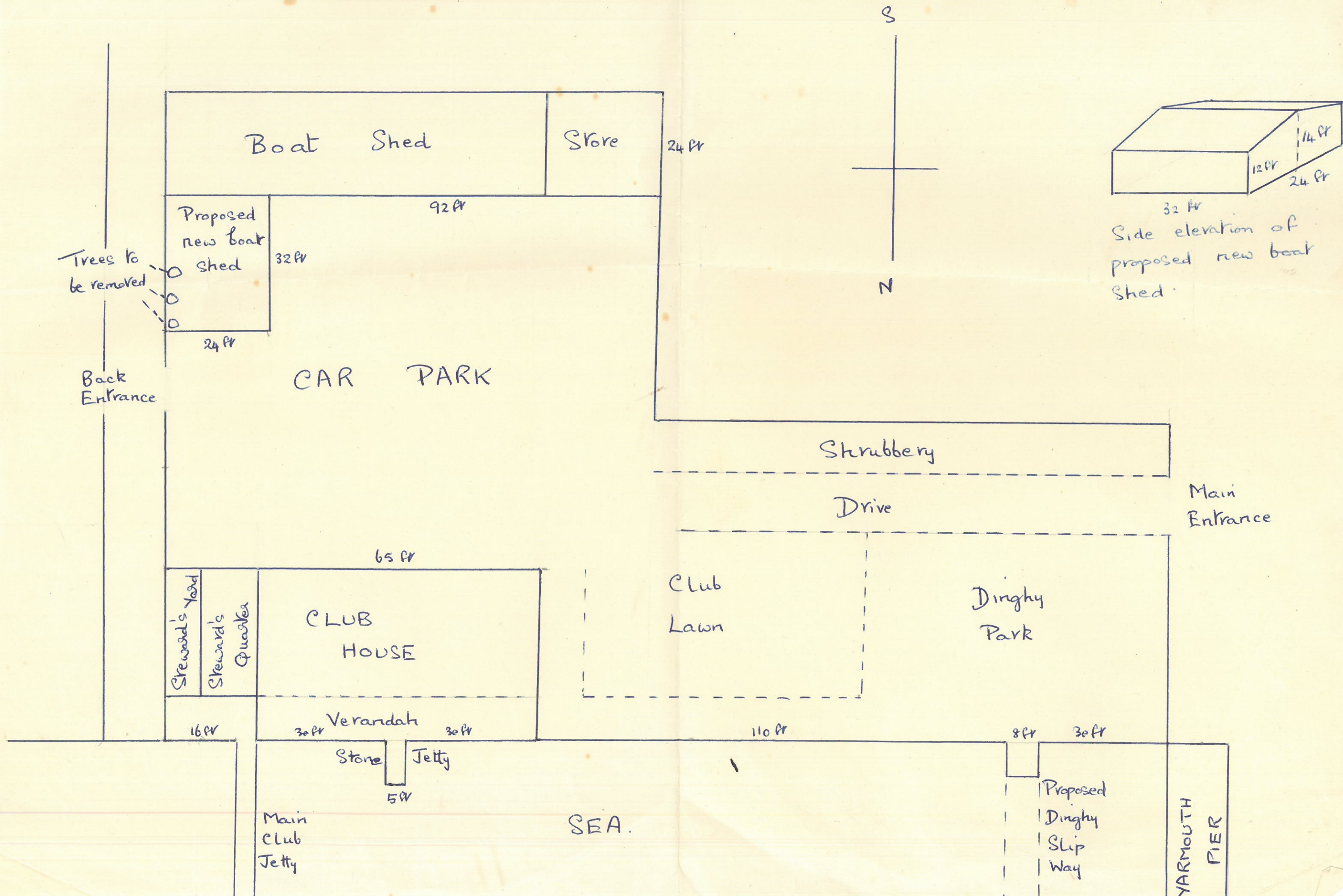



24 FEB 1964

Scale: 8 Feet to One inch

R. L. L. v.

Isle of Wight County Council

This is the plan referred to  
in Planning Decision No.  
TCP/5446/02/7522.

Initials Shs



Scale: 1/2" = 1'-0"



THE TOWERS



Scale:  $\frac{1}{2}$  inch to One Foot

